

'Le Lyrial' Deck Plan

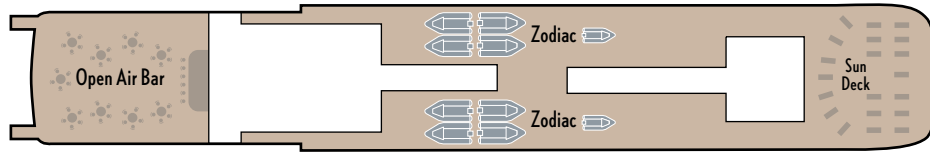

DECK 7

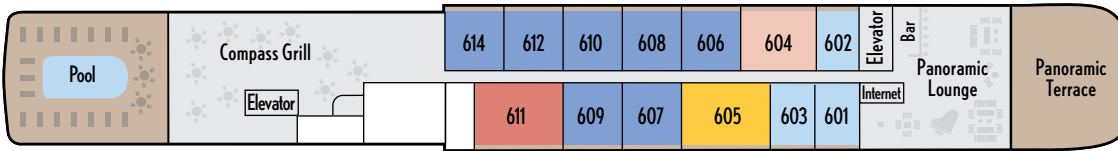

DECK 6

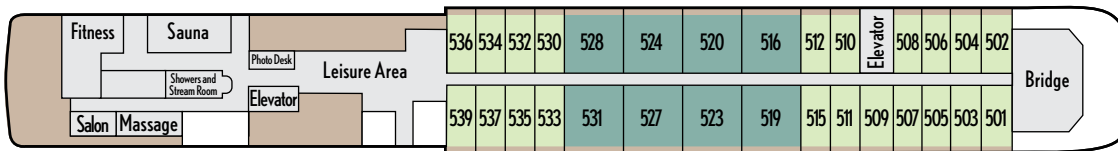

DECK 5

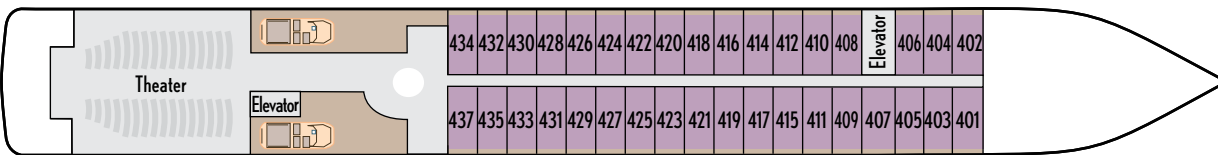

DECK 4

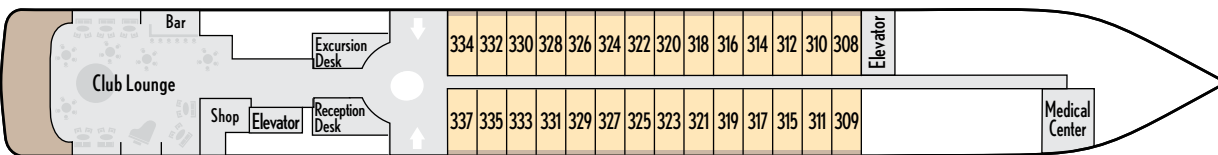

DECK 3



DECK 2

Categories for Staterooms & Suites

SUITES INCLUDING BUTLER SERVICE:

- | | | |
|---|---|---|
| <ul style="list-style-type: none"> ■ Category 9
Owner's Balcony Suite ■ Category 8
Grand Privilege Three-Room Balcony Suite ■ Category 7
Grand Deluxe Two-Room Balcony Suite | <ul style="list-style-type: none"> ■ Category 6
Privilege Two-Room Balcony Suite ■ Category 5
Premier Two-Room Balcony Suite ■ Category 4
Prestige Balcony Suite | <ul style="list-style-type: none"> ■ Category 3
Premier Balcony Stateroom ■ Category 2
Deluxe Balcony Stateroom ■ Category 1
Classic Balcony Stateroom |
|---|---|---|



Exceptional luxury in a Grand Privilege Three-Room Balcony Suite



The Grand Deluxe Two-Room Balcony Suite



Space and style in a Prestige Balcony Suite



A modern Balcony Stateroom

Staterooms & Suites Layout

Owner's Balcony Suite (Category 9)

Cabin: 581 sq. ft. (54 sq. m.)
Balcony: 129 sq. ft. (12 sq. m.)

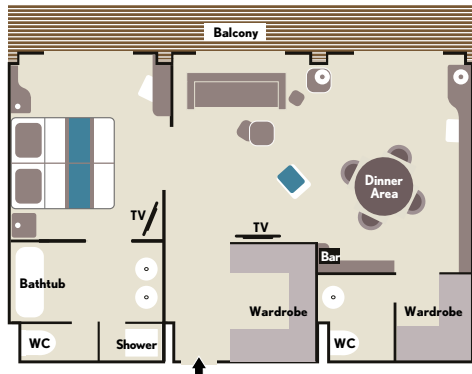

Grand Privilege Three-Room Balcony Suite (Category 8)

Cabin: 581 sq. ft. (54 sq. m.)
Balcony: 129 sq. ft. (12 sq. m.)

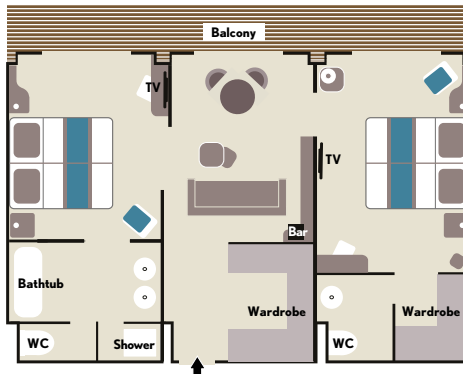

Grand Deluxe Two-Room Balcony Suite (Category 7)

Cabin: 484 sq. ft. (45 sq. m.)
Balcony: 108 sq. ft. (10 sq. m.)

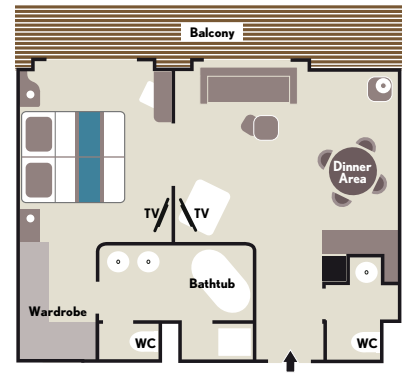

Privilege Two-Room Balcony Suite (Category 6)

Cabin: 388 sq. ft. (36 sq. m.)
Balcony: 86 sq. ft. (8 sq. m.)

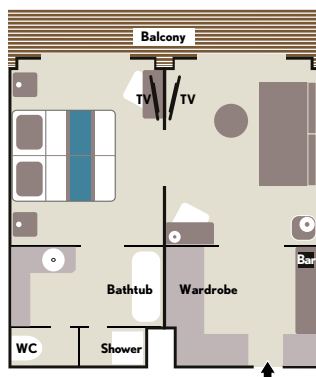

Premier Two-Room Balcony Suite (Category 5)

Cabin: 388 sq. ft. (36 sq. m.)
Balcony: 86 sq. ft. (8 sq. m.)

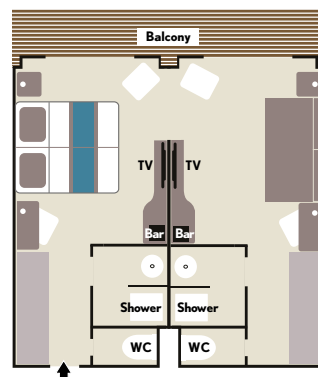

Prestige Balcony Suite (Category 4)

Cabin: 291 sq. ft. (27 sq. m.)
Balcony: 65 sq. ft. (6 sq. m.)

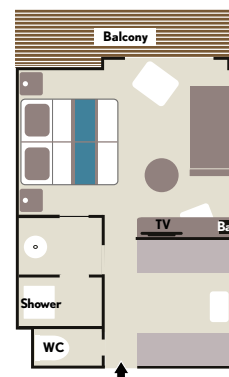

Balcony Staterooms (Categories 1-3)

Cabin: 200 sq. ft. (18 sq. m.)
Balcony: 43 sq. ft. (4 sq. m.)

